

# Dual Door Wafer Check Valve

## Model: SD-16CV-W

The SD-16CV-W Check valve is manufactured to BS EN 12334. Dual Door Check valve is a compact body usually a wafer design. It has a hinge pin which two opposing D-shaped disc rotate and torsion spring wraps down the hinge pin. Suitable for mounting in both horizontal and vertical pipeline.



## Product Specifications:

Working Pressure	PN16
Working Temperature	-20°C - 120°C
Mounting Flange	BS EN1092-2

# Dual Door Wafer Check Valve

## Product Dimensions:

### Dual Door Wafer Check Valve

DN	L	D	D1	D2
50	54	107	64	46
65	54	127	78	60
80	57	142	94	70
100	64	162	117	84
125	70	192	145	115
150	76	218	170	134
200	95	273	224	184
250	108	328	265	220
300	143	378	310	260
350	184	438	360	302
400	194	489	410	350

**NOTE:**

- ▶ Dimensions are in mm
- ▶ PN25 rated valves are also available upon request.

## Drawing Specification

No.	Part	Material
1	Body	Ductile Iron
2	Disc	Stainless Steel 304
3	Stem	Stainless Steel 304
4	Spring	Stainless Steel 304
5	Rubber Seat	EPDM

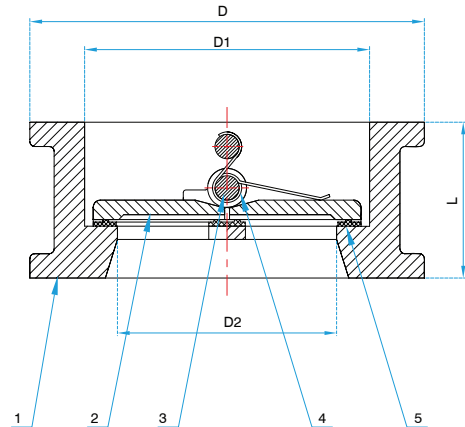

# Dual Door Wafer Check Valve

## Miscellaneous Data:

### 1. Ordering Information

Example: SD-16CV-W-50

- SD-16CV-W is the part number
- (50) Size

### 2. Contact Information

For further information on any aspect of the SHIELD Valves products please contact below:

MIDDLE EAST & AFRICA	UNITED KINGDOM
Jebel Ali Free Zone, Dubai, UAE P.O Box: 61199 Tel.: +971 4 881 2070 Fax: +971 4 881 2198 Email: shieldme@shielglobal.com	Unit 3, Endeavor Drive, Basildon-Essex, SS3 14WF Tel.: +44 1708 377731 Fax: +44 1708347637 Email: shielduk@shielglobal.com